



USER'S MANUAL

THANK YOU FOR YOUR TRUST

Skywalk GmbH & Co. KG congratulates you on the purchase of your X-GL00 Inflatable Display Wall.

In order to guarantee the perfect operation, optimal function, long product life and your personal safety and the safety of your guests, please note the following:

Before you use your Inflatable Display Wall for the first time, read this user's manual carefully and follow the safety indications.

All functions, maintenance and repairs should only be carried out to the degree described in this manual.

Please contact your X-GL00 Team for repairs exceeding these instructions!

If you have any further questions, we are always happy to assist you:

Service Hotline
+44 (0)28 9267 1859

<u>SPECIFICATIONS</u>	<u>3</u>	Connecting the Aluminum Supports	5	<u>REPAIR</u>	<u>10</u>
<u>CONTENTS OF DELIVERY</u>	<u>3</u>	Connecting the Inflatable Support	5	<u>CLEANING</u>	<u>10</u>
<u>SETUP</u>	<u>4</u>	4. Inflate	6	<u>F.A.Q.</u>	<u>11</u>
1. Lay out the Inflatable Frame	4	5. Anchor against strong winds	7	<u>SPECIAL INFORMATION</u>	<u>12</u>
2. Attach Wall Print to Inflatable Frame	4	<u>BLOCK-BUILDING SYSTEM</u>	<u>9</u>		
3. Connect Optional Support(s)	5	<u>TAKE DOWN</u>	<u>9</u>		

SPECIFICATIONS / CONTENTS OF DELIVERY



X-GLOO INFLATABLE DISPLAY WALL

- 1x - Inflatable Frame (1)
- 1x - Wall Print (2)
- 1x - Anchoring Lines and Line Tensioners (3)
- 1x - Trolley (4)
- 1x - Bag for Wall Print (5)
- 1x - Hand Pump (6)
- 1x - User's Manual (7)
- 1x - Repair Patch Set (8)

INDOOR PACKAGE INCLUDES

- 2x - Aluminum Support (9)

OUTDOOR PACKAGE INCLUDES

- 1x - Inflatable Support (10)
- 4x - Connection Bolt (11)
- 1x - Fill Hose (12)
- 1x - Peg Set (13)

OPTIONAL

- Protection Foil
- Electric Pump
- Water Ballast Barrel(s)

INFLATABLE FRAME (1)

Width 3,00 m
 Height..... 2,25 m
 Tube Diameter..... 21,00 cm
 Length including Inflatable Support 1,29 m

WALL PRINT (2)

Width 2,79 m
 Height..... 2,04 m
 Aspect Ratio 4:3

WEIGHT



Inflatable Frame with
 Wall Printca. 12,00 kg
 Inflatable Supportca. 5,20 kg
 Aluminum Supports ca. 3,20 kg

SETUP



Hand Pump ca. 10 min
 Electric Pump..... ca. 2-3 min

OPERATING PRESSURE

Inflatable Frame /
 Inflatable Support ..0,5 bar/7,25 PSI

SETUP*

1 Lay out the Inflatable Frame

- 1.1:** Take the Wall Print out of the provided bag and spread it out—front-side down—in the area intended for setup.

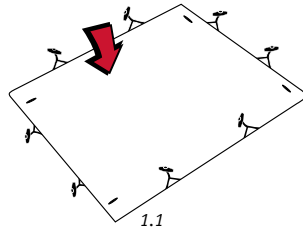

- 1.2:** Spread out the Inflatable Frame on top of the Wall Print, making sure that the quick setup instructions printed on the Frame are visible and are positioned at the bottom-right corner.

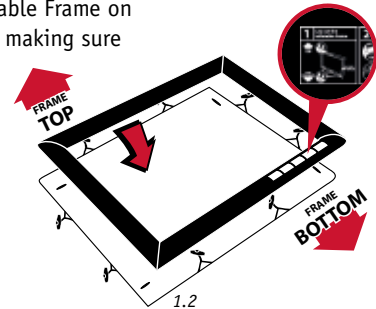

2 Attach Wall Print to Inflatable Frame

- 2.1:** Pass the two D-rings on the bottom corners of the Inflatable Frame through the corresponding openings on the corners of the Wall Print.

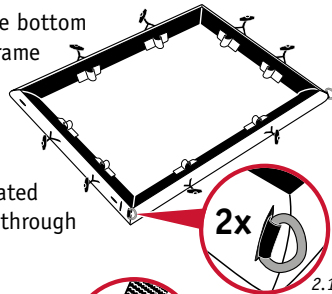

- 2.2:** Pass the four shackles, located on the sides of the Frame, through the openings on the sides of the Wall Print which are equipped with velcro.



- 2.3:** Thread one end of each velcro strip through the shackle and fasten it on the opposite side.



- 2.4:** Thread the eight toggle buttons on the Wall Print through the attachment loops on the Frame.

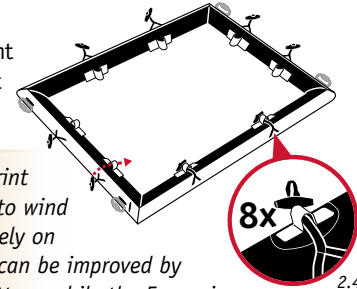

CAUTION: If the Wall Print is strained by exposure to wind or weather and fits loosely on the Frame, then the fit can be improved by adjusting the toggle buttons while the Frame is deflated. To do this, loosen the knot which is tied around the toggle button. Then slide the toggle button toward the loose tail of the webbing to loosen the Wall Print, or away from the loose tail of webbing to tighten it. Re-tighten the knot around the toggle button when finished.

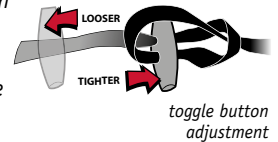

* We recommend the use of our Protection Foil during the first setup in order to protect the Wall Print from dirt and damage.

3 Connect Optional Support(s)

3.1: CONNECTING THE ALUMINUM SUPPORTS

Each Aluminium Support consists of a vertical pipe (1) and a horizontal profile (2). To connect the two pieces, insert the t-shaped screw on the bottom of the pipe firmly into the track on the profile and then turn the pipe clockwise until the two parts are held tightly together.

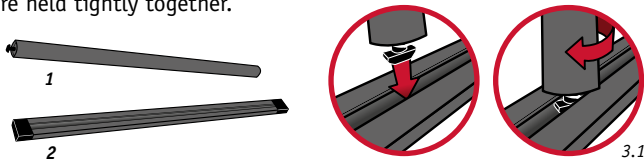

3.1.1: Connect the Supports to the Frame by sliding the pipes into the large slots on the sides of the Wall Print found just above the D-rings, and then through the connection pockets on the Frame (two on each side).

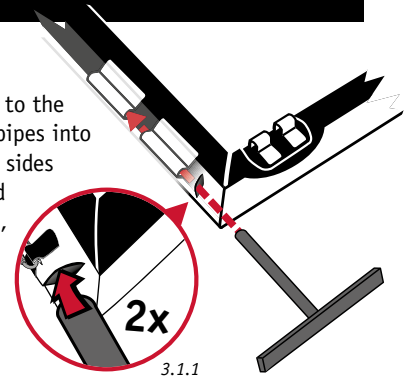

3.2: CONNECTING THE INFLATABLE SUPPORT

3.2.1: Arrange the Inflatable Support on top of the Frame so that the connection loops on the tube ends line up with the connection loops on the Frame.

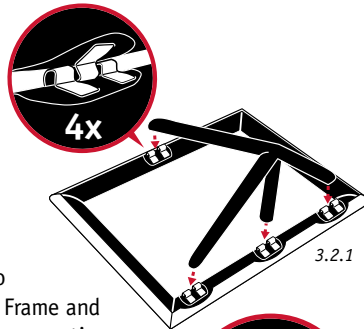

3.2.2: Position the loop on the Support between the two connection loops on the Frame and then slide the aluminum connection bolt through all three loops. Repeat this process on each of the four tube ends.

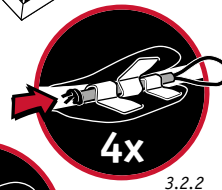

3.2.3: Secure each connection bolt with the retaining leash to prevent them from falling out while the Display Wall is deflated.



CAUTION: The Inflatable Support can only be connected or disconnected while both the Support and the Frame are deflated.

PLEASE NOTE: It is possible to adjust the angle of the Inflatable Display Wall by using anchoring lines to tension between the Frame and the Inflatable Support.

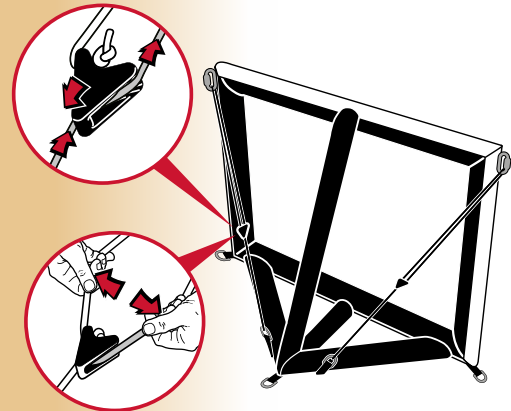

SETUP

4 Inflate

4.1: Turn the bottom housing of the inflation valve clockwise until it is firmly closed.

4.2: Open the cap of the inflation valve.

4.3: Connect the hose from the Hand- or Electric Pump to the inflation valve.

4.4: Inflate.

PLEASE NOTE: The Electric Pump can only inflate the Frame up to 0.25 bar. If higher pressure is needed (for outdoor use for example) the Hand Pump can be used, which can achieve a pressure of up to 0.5 bar.

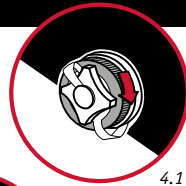

4.1

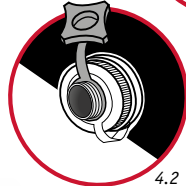

4.2

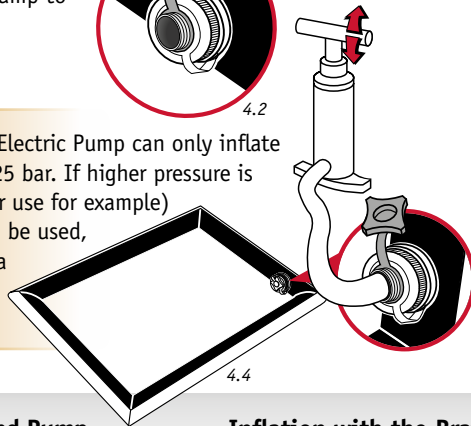

4.4

4.5: Close the inflation valve after inflating the Frame.

4.6 (OPTIONAL) INFLATE THE INFLATABLE SUPPORT: Follow steps 4.1 through 4.5.

CAUTION: The Inflatable Support is equipped with two valves; one inflation valve and one water intake valve. To inflate the Support with air, make sure to use the inflation valve located on the left-hand tube.

PLEASE NOTE: The Inflatable Support can also be partially filled with water to anchor the Display Wall (see page 7).

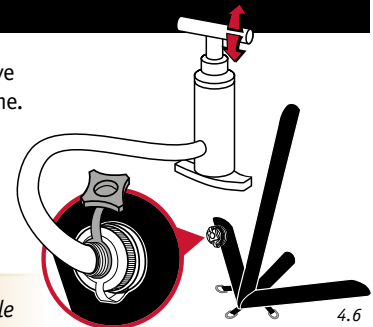

4.6

Inflation with the Hand Pump

The Hand Pump included in the standard delivery is equipped with different valve sockets and an air hose. Do not kink or press down on the air hose to avoid air leakage or damage!

CAUTION: See the notation on the hose connection:

Inflate | Deflate

Inflation with the Bravo OV10* or Bravo 2000* Electric Pump

Screw the hose (included in delivery) to the correct opening on the pump.

CAUTION: See the notation on the hose connection:

IN = Inflate | OUT = Deflate

Connect the plug to the outlet. Please note that the Bravo 2000 has a booster which can be turned on with the switch. Please read and follow the operating instructions included with the Bravo OV10 and Bravo 2000.

*120V and 230V models available.

Inflation with the Bravo Turbo Max for 12V automobile battery

The Bravo Turbo Max can be connected to a 12V automobile battery. To avoid draining your battery, make sure that it is fully charged or that the vehicle is running while operating the pump. Please read and follow the operating instructions included with the Bravo Turbo Max.

Connect the cable clamps to the respective connections of the battery (red = +, black = -) and adjust the pressure control to 3 PSI.

5 Anchor against strong winds

5.1: ANCHORING WITH WATER-FILLED INFLATABLE SUPPORT

Ideal for use on hard- or soft ground surfaces, the Inflatable Support can be partially filled with water and used as a means of anchoring the Display Wall. A fill hose is included in delivery for this purpose.

CAUTION: Be sure to first add water and then afterward fill the remaining space with air.

CAUTION: The Inflatable Support is equipped with two valves; one inflation valve and one water intake valve. Make sure that you use the water intake valve located on the lower middle tube for filling the support with water.



5.1.1: Connect the fill hose to the water intake valve.

5.1.2: Make sure that the inflation valve and the flap (check valve) inside the water intake valve are closed.

5.1.3: Open the cover on the water intake valve and fill the Support with the desired amount of water (up to 125 l, which completely fills the bottom three tubes).

5.1.4: Screw the water intake valve cover tightly closed.

To Empty: To empty, unscrew the housing of the inflation valve so that the water can run out on its own.

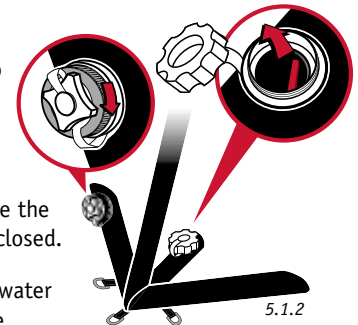

5.1.2

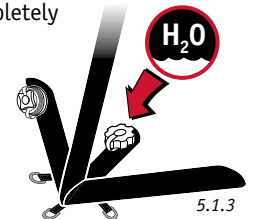

5.1.3

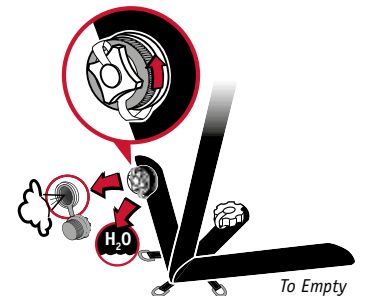

To Empty

SETUP

5 Anchor against strong winds

5.2: ANCHORING WITH THE ANCHORING LINES AND PEG SET

Use the anchoring lines provided with the Display Wall to connect the shackles at the top of the Frame to four tent pegs positioned approximately 2 meters from the base of the Display Wall. Tension the lines with the line tensioners. The remaining tent pegs in the Peg Set can be used to secure the D-rings on the Frame or Inflatable Support as required.

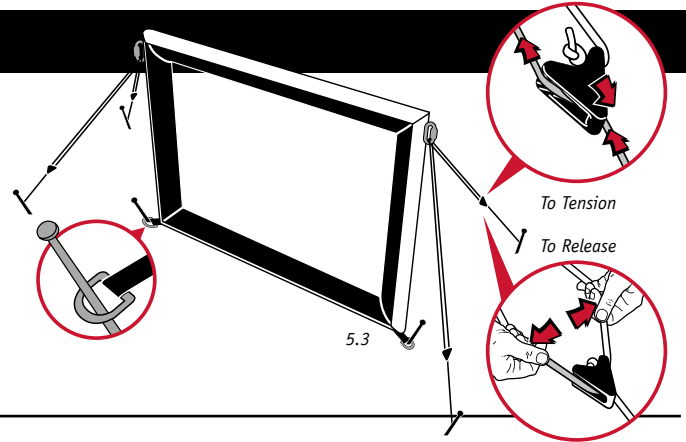

5.3: ANCHORING WITH WATER BALLAST BARRELS

Ideal for use on hard- or soft ground surfaces, Water Ballast Barrels can be used as anchors for the Inflatable Display Wall, as seating, or both.

5.2.1: Open the cover on both valves on the Ballast Barrel. Make sure that the flap inside the check valve at the bottom of the Barrel is closed so that no water or air can escape when filling. Push open the flap inside the top valve so that air can escape.

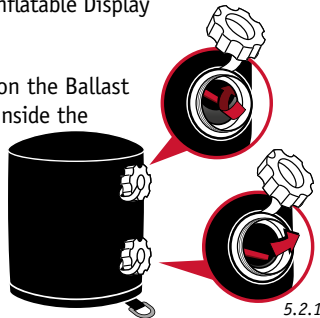

5.2.2: Connect the included fill hose to the valve at the base of the Ballast Barrel and fill with the desired amount of water (up to 80L). To give the Barrel a cleaner appearance, the remaining space can then be filled with air. To do this, connect the black fill hose provided with the Ballast Barrel to the pump in place of the pump's yellow hose.

5.2.3: Disconnect the fill hose from the Ballast Barrel and make sure that the covers of both valves are tightly closed.

5.2.4: With the help of an assistant, carry the Ballast Barrel to your Display Wall location by lifting it by the handles. Or, if you are on your own, tip the Ballast Barrel onto its edge and roll it.

5.2.5: The D-ring at the base of each Ballast Barrel can be connected to one of the the D-rings on the Inflatable Support or the Inflatable Frame by using the included screw shackle. Up to five Water Ballast Barrels can be connected to the Inflatable Display Wall.



To Empty: To empty the Ballast Barrel, simply unscrew the cover on the lower valve and push open the flap inside (see Figure 5.2.1).

BLOCK-BUILDING SYSTEM / TAKE DOWN

BLOCK-BUILDING SYSTEM

Multiple Inflatable Display Walls may be connected with each other by connecting the shackles. To do this, unscrew the horizontal shackles on one Display Wall and slide them over the vertical shackles of the other Display Wall. Then screw the horizontal shackles closed. This can be repeated with as many Walls as desired.

CAUTION: All walls must be properly anchored using one or more of the methods described on pages 5-8.

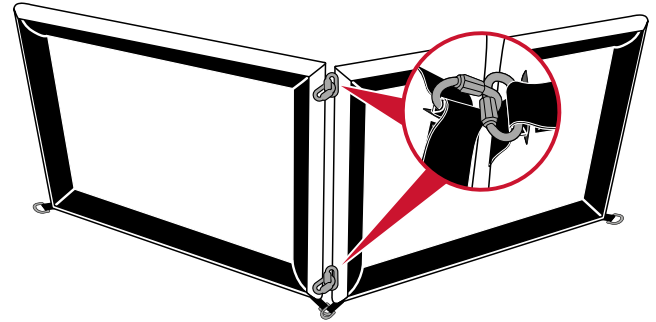

TAKE DOWN

PLEASE NOTE: If you are not planning to exchange the Wall Print for your next use, the Wall Print and support can remain connected to the Frame when being packed into the Trolley.

Make sure that all of the tent pegs are removed and all anchoring lines are disconnected before deflating the Display Wall.

Step 1: Deflate the Frame by unscrewing the housing on the inflation valve.

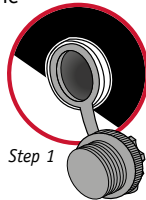

Step 2: If the Inflatable Support is being used, empty and deflate it by unscrewing the housing on the inflation valve located on the left-hand tube.

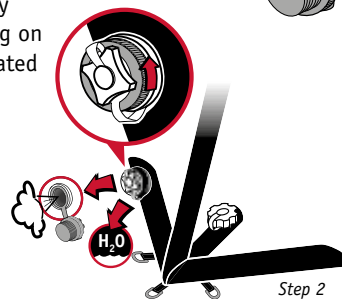

Step 3: If you are exchanging the Wall Print for your next event, please reverse the steps on pages 4-5 to take down the Inflatable Display Wall.

CAUTION: If the Aluminum Supports are being used, the pipes need to be disconnected from the profiles before packing the Display Wall into the Trolley.

PLEASE NOTE: For easier repacking, first detach the Inflatable Support from the Frame.



REPAIR / CLEANING

⚠ All functions, maintenance, and repairs should only be carried out to the degree described in this manual. Please contact your X-GLOO Team for repairs exceeding these instructions!

⚠ PLEASE NOTE: The Inflatable Display Wall should be inspected visually and for functionality at least once a year by an expert. This inspection includes inflating the Display Wall in order to check all pressure-bearing parts for tears, punctures, debonding, or heat- or chemical damage.

REPAIR

The adhesive repair patch resists perforation, is stretch-durable and has been developed especially for repairing tears and holes in the Inflatable Frame or the Inflatable Support.

- High adhesion guarantees impermeability
- Resistant to UV exposure
- Easy to trim
- Resistant to moisture, sand, salt, wind and high temperatures

Step 1: Roughen the area that needs to be repaired using the included roughening pad.

Step 2: Trim the adhesive repair patch to the desired size and carefully remove the protective layer. Try to avoid touching the sticky surface.

Step 3: Press the repair patch onto the repair area and make sure that there is sufficient overlap of the repair area. An overlap of at least 50 mm is recommended for larger tears or holes.

⚠ PLEASE NOTE: Press the repair patch uniformly and firmly (more pressure means that the patch will adhere more quickly).

Step 4: Allow the area to dry for at least two hours – done.



Repair Patch Set

CLEANING

To remove dirt or stains, the Wall Print may be washed using heavy-duty detergent in a washing machine set on the gentle cycle (without spin cycle) with temperatures not exceeding 30° celsius.

⚠ CAUTION: Never use solvents, steam cleaning or gasoline! This destroys the cloth.

What do I do if the Wall Print is wrinkled?

If the Wall Print is wrinkled, then the eight toggle buttons can be adjusted to retighten the print while the Frame is deflated (see page 4).

How long does it take to exchange the Wall Print?

An exchange of the Wall Print approximately 10 minutes. Please follow steps 1.1 to 3.2 on pages 4-5.

Can the Inflatable Display Wall get wet?

The Inflatable Display Wall can get wet. However, the product should not be packed or stored when damp or wet since this can cause the formation of mold spots and discoloration.

How can I secure the Display Wall against high winds?

When using the appropriate anchoring option; e.g. water-filled Inflatable Support, Tent Peg Set, or brandable Water Ballast Barrels, it is easy to secure the Inflatable Display Wall in locations with high winds. Please refer to the Wind Resistance Certificate on our website for details.

Is the Inflatable Display Wall always delivered with both the Aluminum and Inflatable Supports?

The Inflatable Display Wall is not always delivered with the Aluminum Support and Inflatable Supports. These can be optionally purchased in addition to the Inflatable Frame and Wall Print.

Why is the Inflatable Display Wall not equipped with an overpressure valve?

Since the PVC material used for the Frame of the Inflatable Display Wall is very robust, the maximum pressure of the Hand- or Electric Pump available from X-GLOO cannot damage the Inflatable Frame or Support. Therefore no overpressure valve is necessary.

CAUTION: Do not use an air compressor to inflate the Inflatable Frame or Support.

Which one is the inflation valve and which one is the water intake valve?

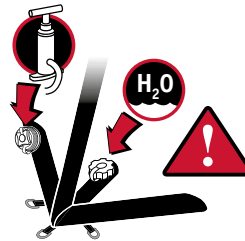

Is the Inflatable Display Wall always delivered with a Protection Foil?

The Protection Foil can be purchased separately and is not included in the standard delivery of the Inflatable Display Wall. We recommend the use of our Protection Foil during the first setup to protect the Wall Print from dirt and damage.

Do I always need to lay the Wall Print face-down when setting up the Inflatable Display Wall?

If you are planning on using the Display Wall with the Indoor Supports or if the Wall Print and support are already connected to the Frame, then the Wall Print can also be spread out printed-side up.

Can the Inflatable Display Wall be washed in the washing machine?

To remove dirt or stains, the Wall Print may be washed using heavy-duty detergent in a washing machine set on the gentle cycle (without spin cycle) with temperatures not exceeding 30° celsius.

Should the Inflatable Support first be filled with air or with water?

If using the Inflatable Support to anchor the Display Wall, water should be added first and then the remaining space in the Support can be filled with air.

How many Water Ballast Barrels can be attached to the Display Wall?

Up to five Water Ballast Barrels can be connected to the Inflatable Display Wall Frame and optional Inflatable Support (see page 8).

Can multiple Display Walls be connected to one another?

Yes, it is possible to connect multiple Inflatable Display Walls with each other (see page 9).

SPECIAL INFORMATION

GRAPHICS/DESIGN

- A transparent effect can occur (especially with background light) with different color combinations (light Wall Print in combination with black Frame). This should be taken into consideration by customers when designing the Inflatable Display Wall. If in doubt, please consult your X-GLOO professional.

SETUP

- Do not exceed the specified maximum air pressure (0,5 bar/7,25 PSI).
- The Inflatable Display Wall is not intended for long-term outdoor use and should be inspected for wear or damage after every event.
- The Display Wall should be deflated in winds exceeding 60 km/h.



PLEASE NOTE: When high wind force is expected the Display Wall must be secured and anchored. For this reason, please pay special attention to the following points:

- According to the ground surface, you may require longer or additional stabilization materials.
- Additionally, you must attach anchoring lines to the shackles on the corners of the Frame.
- Only Water Ballast Barrels are sufficient for securing your Display Wall against strong wind gusts (see Wind Resistance Certificate).
- Winds stronger than 60 km/h can lead to structural damage of the Display Wall and this damage is no longer covered by the warranty.
- If weather conditions deteriorate dramatically, all valves should be opened immediately and the Inflatable Frame and Support deflated. Additionally, the deflated Display Wall should be weighed down.
- In general, the bottom of the Inflatable Frame and Support are exposed to more wear-and-tear on rough surfaces through movement due to wind.

OPERATION

Keep open fires and heat sources away from the Inflatable Display Wall.

FIRE PROTECTION CLASSIFICATION:

• Description of Norms:

- DIN 4102-B1 (Abb.: B1) Controls testing and requirements on the reaction to fire of building materials.

German norm, used in most European countries. Due to the fact that the Display Wall is in use worldwide at tradeshow and events as an information carrier, we reserve the right not to certify the Display Wall according to the national norms of each country.

- When the Display Wall is used in sandy terrain, avoid getting sand grains in the pump.
- The Display Wall can be damaged by the penetration of sharp objects (e.g. knives, tools) in the Inflatable Frame or Support causing leakage and loss of pressure. Handle the Display Wall with appropriate care.
- The valves should be kept free of sand and dirt and cleaned if necessary, otherwise malfunction and air-pressure loss may occur.
- Avoid extreme variations in temperature (day and night) or long-term use. This can lead to loss of air pressure, requiring reinflation of the Display Wall.

Procedure in the case of pressure loss:

- FIRST close all valves TIGHTLY!
- If pressure loss still continues, a damaged Inflatable Frame or Support is likely the cause.
 - If the damage is visible, please proceed as described on page 10.
 - If the damaged area cannot be found, spray some soap suds onto the inflated Frame or Support so that the escaping air bubbles are visible and the damage can be located. Then apply the adhesive repair patch (see page 10).

SPECIAL INFORMATION

STORAGE

- Avoid pressure spots (e.g. do not kneel on the Inflatable Display Wall while folding it up).
- Store the Display Wall in a dry location and at temperatures not exceeding 40° celsius.
- Do not pack or store the Display Wall when damp or wet, since this can cause the formation of mold spots and discoloration.
- At temperatures lower than 0° celsius, folding can lead to damage of the components.
- Never store the Display Wall in an automobile in direct sunlight. The intense heat may cause permanent damage to the parts.

MAINTENANCE, CLEANING, REPAIR

Please contact our customer service team with any questions regarding repairs and maintenance.

- Maintenance and repairs should be carried out only by X-GL00 or by an authorized Service Center.
- The Display Wall should be periodically inspected for chafe marks and damage and promptly repaired.

MATERIAL

The Inflatable Frame and Support do not have a bladder inside since the PVC (Poly Vinyl Chloride) material can be directly filled with air. The PVC material is very robust and still flexible since it only consists of one layer. Furthermore it is air- and water tight, as well as fire resistant and easy to clean.

- Bleaching of the material is possible with extended UV exposure (e.g. at high altitude or extended setup time). It is practically impossible to state when exactly a color change could become visible, since the influencing factors vary strongly. All of the materials currently being used have been subjected to extensive material testing.
- The materials for the Inflatable Frame and Support are waterproof.

